

# Quick start guide CCS-HEAT-DETECTOR

## Care Call heat detector



### Getting started

Any questions? Call us on 01246 450789

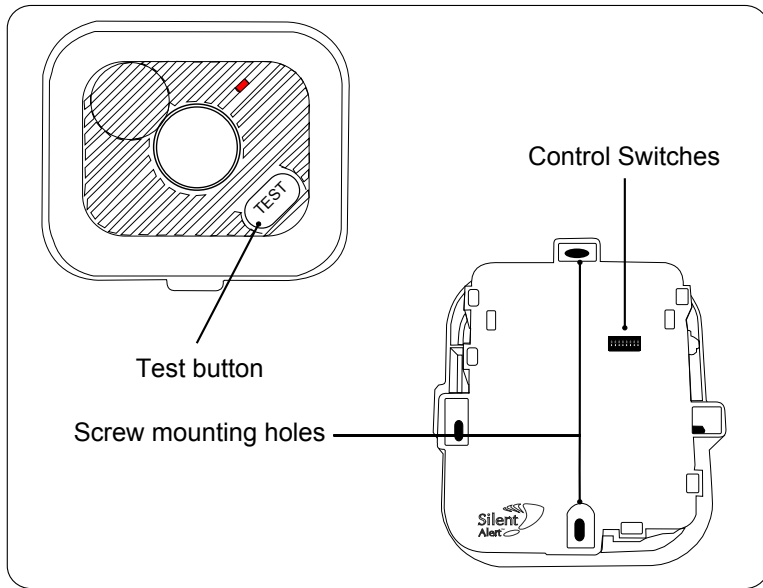

1.

Install a 9V PP3 battery into the unit.  
NOTE: Only use alkaline or lithium batteries.

2.

Press the heat detector test button whilst holding the alarm in the desired location.

Refer to the separate EI instructions for the heat detector to determine the best position for the unit.

Check the Pager or SignWave has received the signal before fixing in place.

3.

An Alkaline battery should last 2 years or more, a lithium battery can last 5 - 10.

Low battery signals will be sent to your Pager or SignWave when the battery needs changing.

4. Push the button not your luck

Check your smoke alarms every week by pressing the test button.

For extra reassurance we recommend changing the battery once a year on your birthday or a similar memorable date.

Only replace the battery with an Alkaline or Lithium PP3 battery

**WARNING!** Your device and its accessories are not toys. They may contain small parts. Keep them out of the reach of small children.

