

Quick start guide CCS-SMOKE-ION/OPTO

Care Call wireless smoke alarms



Getting started

Any questions? Call us on free phone 0800 387 397

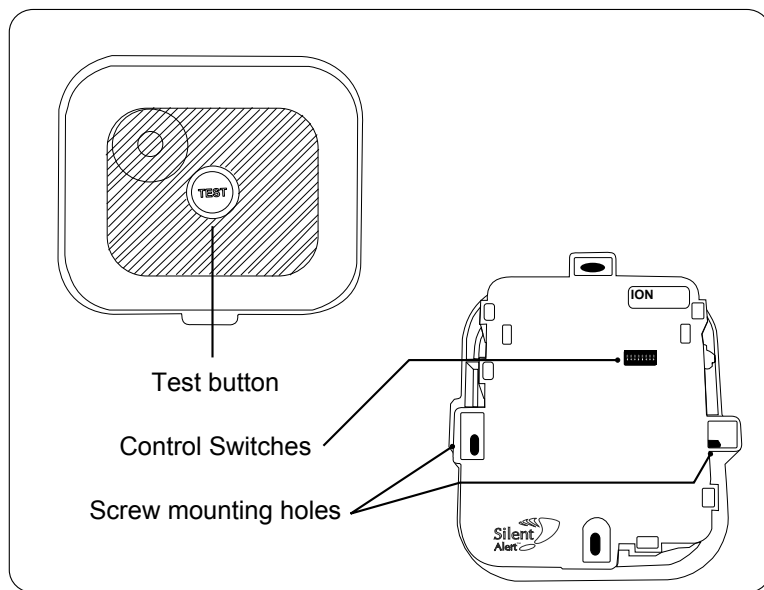

1.

Remove the battery cover & install a 9V PP3 battery into the unit.

NOTE: Only use alkaline or lithium batteries.

2.

Snap the battery cover back onto the unit. This can be secured with a 3mm self tapping screw (not supplied) if required.

Battery cover screw hole

Battery cover in place

3.

Press the smoke alarm test button whilst holding the alarm in the desired location.

Check the Pager or SignWave has received the signal before fixing in place.

Refer to the separate instructions for the smoke alarm to determine the best position for the unit.

4.

An Alkaline battery should last 2 years or more, a lithium battery can last 5 - 10.

Low battery signals will be sent to your Pager or SignWave when the battery needs changing.

5. Push the button not your luck

Check your smoke alarm every week by pressing the test button.

For extra reassurance we recommend changing the battery once a year on your birthday or a similar memorable date.

WARNING! Your device and its accessories are not toys. They may contain small parts. Keep them out of the reach of small children.

Any questions? Call us on free phone 0800 387 397

Changing the zone

NOTE. If you want to use more than one smoke alarm or have a monitor already set to zone one, the smoke alarm can be configured to another zone as follows.

The monitor is supplied with no zone switches set (zone 1). For reference this is the factory setting should you need to re-set the unit.

Zones can be set using key switches 5 - 8. The diagram to the right shows the 12 possible combinations.

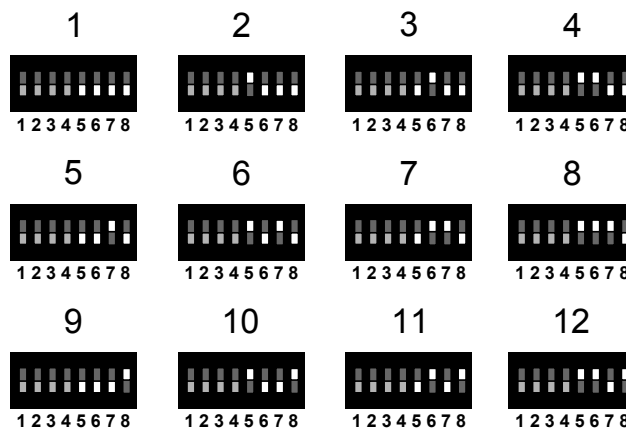

Changing the system channel code

NOTE. In most cases it is not necessary to change the system code. However, when one or more systems are in close proximity, system codes can be used to avoid interference from other Care Call systems using up to a maximum of 16 system channels.

The monitor is supplied with no system code switches set (system code 1). For reference this is the factory setting should you need to re-set the unit.

System codes can be set using key switches 1 - 4. The diagram to the right shows the 16 possible combinations. Be sure that the same system code is set on the receiver to be used and any other monitors in that system.

