

# Quick start guide CCF3A-2219-EU / GFOB

## Care Call Emergency person to person keyfob



### Standard Activation

Any questions? Call us on free phone 0800 387 397

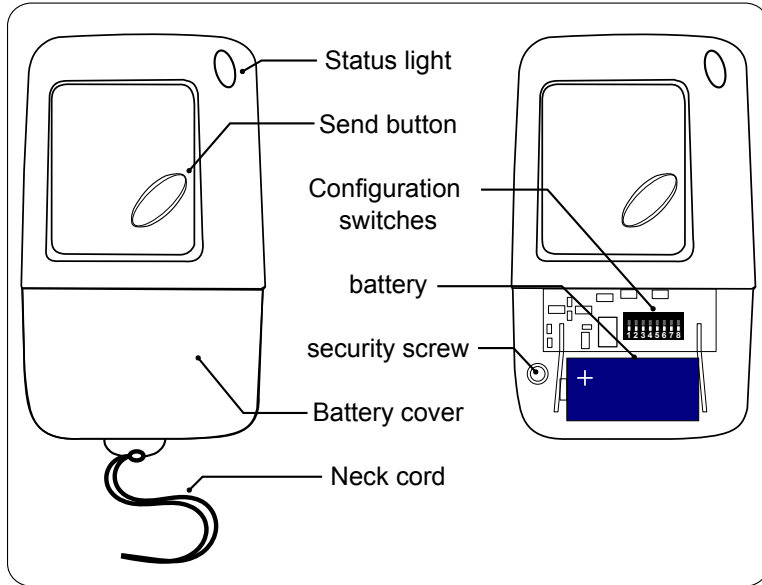

1. A battery is already installed in the Keyfob.

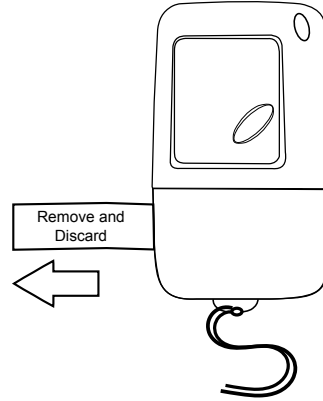

To activate the unit simply remove the paper tab by pulling it gently away from the unit.

The keyfob is now ready to go and is set to illuminate zone 1 by default.

2. Sending a signal

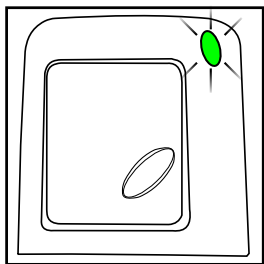

The supplied lithium battery should provide a large number of activations

Press the send button. The status light will shine green and the Pager or SignWave should receive a Zone 1 signal

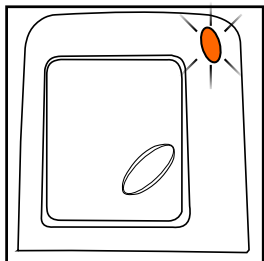

If the light shines orange when the button is pressed the internal battery is low and should be replaced (see step 3).

3. Low battery

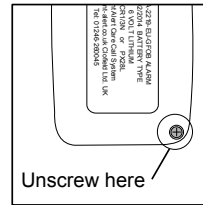

When the battery needs replacing remove the screw from the rear of the unit.

Turn the unit over and gently push the battery cover upwards exposing the battery and configuration switches.

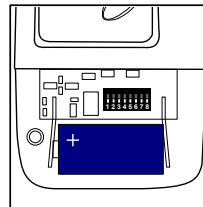

Replace with a 6V lithium battery (2CR1/3N OR PX28L)

### CCF3A-2219-EU-GFOB Shock detection activation

The CCFA-2219-EU-GFOB variant incorporates a sensor which will trigger the unit automatically when the device receives a shock.

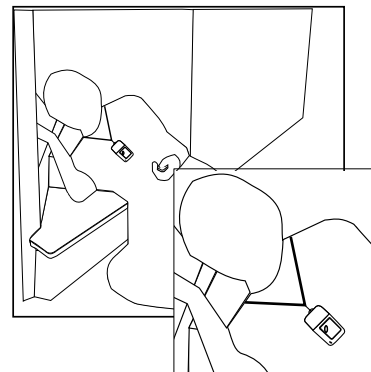
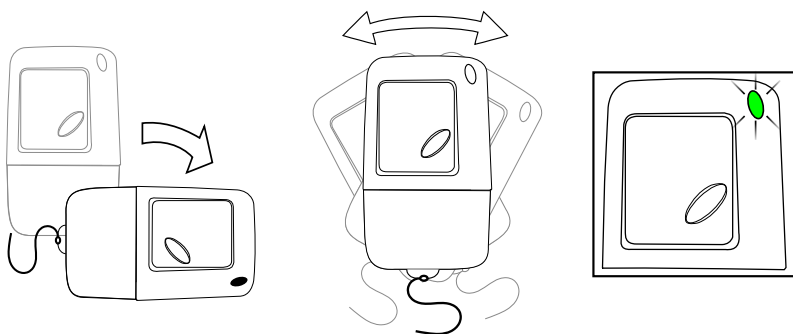

For best results we recommend the using the neck cord provided to allow the keyfob to hang around the neck. Placing the keyfob in a pocket may reduce the effectiveness of the shock sensor.

Any questions? Call us on free phone 0800 387 397

### Changing the zone

**NOTE.** If you want to use more than one keyfob or have a monitor already set to zone one, the keyfob can be configured to another zone as follows.

The monitor is supplied with no zone switches set (zone 1). For reference this is the factory setting should you need to re-set the unit.

Zones can be set using key switches 5 - 8. The diagram to the right shows the 12 possible combinations.

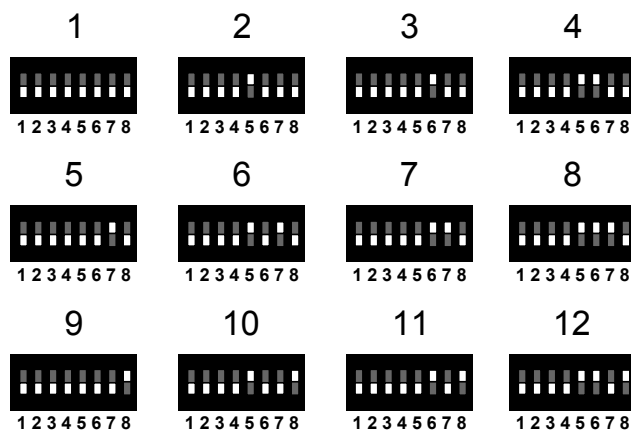

### Telecare SignWave activation

**NOTE.** The following setting will not activate a standard Care Call Pager & SignWave. Only use them with the Care Call CCS3A-2217-EU-TL.

When configured in this way the Keyfob will only activate the Care Call Telecare Link SignWave.

This can be used to trigger an auto dialler or other third party equipment.



#### WARNING! PRODUCT CONTAINS A LITHIUM BATTERY.

Battery can explode or leak if heated, disassembled, shorted, recharged, exposed to fire or high temperature or inserted incorrectly. Keep in original package until ready to use. Do not carry batteries loose in your pocket or purse.

**Keep batteries away from children. If swallowed, consult a physician at once.**

Under certain misuse conditions and by abusively opening the battery, exposed lithium can react with water or moisture in the air causing potential thermal burns or fire.

### Changing the system channel code

**NOTE.** In most cases it is not necessary to change the system code. However, when one or more systems are in close proximity, system codes can be used to avoid interference from other Care Call systems using up to a maximum of 16 channels.

The monitor is supplied with no system code switches set (system code 1). For reference this is the factory setting should you need to re-set the unit.

System codes can be set using key switches 1 - 4.

The diagram to the right shows the 16 possible combinations.

Be sure that the same system code is set on the receiver to be used and any other monitoring options in that system.

